



FURY EDGE



USER MANUAL

21+

THANK YOU FOR PURCHASING THE HEALTHY RIPS **FURY EDGE SE!** PLEASE READ & FOLLOW THE INSTRUCTIONS CAREFULLY BEFORE FIRST USE. IT IS RECOMMENDED THAT THESE INSTRUCTIONS ARE SAVED FOR FUTURE REFERENCE.

THE **FURY EDGE SE** IS DESIGNED FOR AROMATHERAPY USE ONLY. YOU MUST BE AT LEAST 21 YEARS OR OLDER TO PURCHASE & USE THE **FURY EDGE SE.** ANY ILLEGAL USE OF THIS DEVICE COULD SUBJECT THE USER TO FINES, PENALTIES, AND/OR IMPRISONMENT UNDER THE LAW OF YOUR JURISDICTION.

THIS PRODUCT SHOULD NOT BE USED BY CHILDREN, WOMEN WHO ARE PREGNANT OR BREASTFEEDING, OR THOSE WITH LIFE THREATENING ILLNESSES WITHOUT FIRST CONSULTING A DOCTOR. IF YOU HAVE ANY HEALTH ISSUES, CONSULT YOUR DOCTOR BEFORE USING THIS DEVICE.

**WE SINCERELY HOPE YOU ENJOY THE QUALITY & PERFORMANCE OF
YOUR NEW FURY EDGE SE!**

INCLUDED IN THE BOX:

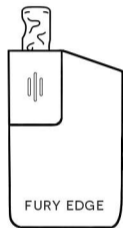

**DEVICE,
STANDARD
MOUTHPIECE,
COOLING STEM**



**TRAVEL
MOUTHPIECE**



TRAVEL COVER



**O-RING,
SCREEN**



**[CLEANING KIT]
TWEEZERS,
CLEANING TOOL,
CLEANING BRUSH**

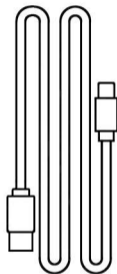

USB-C CORD

FURY EDGE SE OVERVIEW:

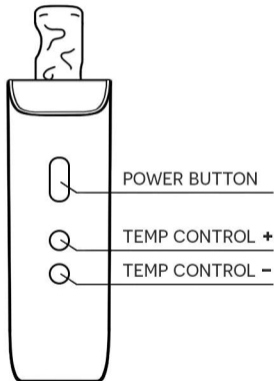

AIR HEATING



USB-C CORD



HEATS UP IN
25 SECONDS



USE WHILE
CHARGING



ADJUSTABLE
280°F-430°F



ADJUSTABLE
TIMER

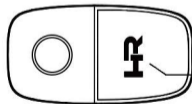

OLED DISPLAY

SPECIFICATIONS:

SIZE	90.5 X 51.8 X 27.4 mm (3.5 X 2 X 1 in)
WEIGHT	5.6 oz
BATTERY	2300 mAh LITHIUM-POLYMER
CHARGING VOLTAGE/CURRENT	5V/1.5A
CHARGING TIME	~90 min
SESSION TIMER (AUTO SHUT-OFF)	ADJUSTABLE BETWEEN 3-7 min
TEMPERATURE RANGE	280°F - 430°F / 138°C - 221°C
HEAT-UP TIME	~25 sec
HEATING TYPE	CONVECTION TECHNOLOGY
HEATING COIL	STAINLESS STEEL
CHAMBER	11 mm FOOD GRADE STAINLESS STEEL
AIR PATH	ISOLATED FOOD GRADE STAINLESS STEEL
VAPOR PATH	GLASS

FURY EDGE SE START-UP:

1. CHARGE THE DEVICE FOR 2 HOURS BEFORE FIRST USE.
2. THE BATTERY WILL STOP CHARGING WHEN THE BATTERY ICON  IS FULL.
3. TURN THE DEVICE ON THE MAXIMUM TEMPERATURE FOR A COMPLETE 5 MINUTE CYCLE TO BURN-OFF ANY MANUFACTURING RESIDUE.
4. WHEN THE BATTERY LEVEL IS LOW - CHARGE THE DEVICE WITH THE INCLUDED USB-C CORD.
5. DO NOT CHARGE OVERNIGHT OR UNATTENDED.

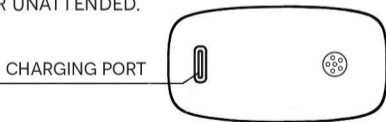

IMPORTANT FEATURES:

1. POWER ON OR OFF: RAPIDLY CLICK THE POWER BUTTON 3 TIMES WITHIN 2 SECONDS.
2. FLIP THE DISPLAY SCREEN: PRESS & HOLD THE POWER BUTTON FOR 3 SECONDS.
3. CHANGE THE DISPLAY FROM FAHRENHEIT TO CELSIUS OR FROM CELSIUS TO FAHRENHEIT: PRESS & HOLD THE POWER BUTTON & THE [-] BUTTON SIMULTANEOUSLY FOR 2 SECONDS.
4. ADJUST THE DEVICE TO DESIRED TEMPERATURE: CLICK THE [+] OR [-] BUTTONS.
5. ADJUST THE SESSION TIMER: PRESS & HOLD THE POWER BUTTON & THE [+] BUTTON SIMULTANEOUSLY FOR 2 SECONDS TO ENTER THE SESSION TIMER 'SET' MODE. THEN CHANGE THE TIMER BY PRESSING THE [+] OR [-] BUTTONS.
6. CHECK THE BATTERY LEVEL WHILE THE DEVICE IS OFF: PRESS THE POWER BUTTON ONCE.
7. PASS-THROUGH CHARGING: USE THE DEVICE WHILE CHARGING WITH AT LEAST 20% BATTERY LIFE.

USING THE FURY EDGE SE:

1. LOAD DRY HERBS INTO THE CHAMBER & REPLACE THE MOUTHPIECE.
2. CLICK THE POWER BUTTON 3 TIMES RAPIDLY TO TURN ON/OFF. THE DEVICE WILL VIBRATE.
3. THE OLED SCREEN WILL DISPLAY THE DEVICE'S CURRENT TEMPERATURE.
4. THE DEVICE WILL VIBRATE ONCE THE DESIRED TEMPERATURE IS REACHED.
5. THE DEVICE WILL AUTOMATICALLY SHUT OFF TO PRESERVE THE HERBS & BATTERY LIFE. TO ADJUST THE SESSION TIMER SEE PAGE 6.
6. TO REACTIVATE THE DEVICE – CLICK THE POWER BUTTON 3 TIMES RAPIDLY.

WARNING:

ALWAYS STORE DEVICE IN A DRY PLACE TO PROTECT IT FROM THE EFFECTS OF WEATHER.

KEEP OUT OF REACH OF CHILDREN AND/OR UNQUALIFIED PERSONS.

USER TIPS:

1. FOR BEST RESULTS, FILL THE CHAMBER HALFWAY OR MORE & DO NOT PACK DOWN THE HERBS. NOT PACKING THE HERBS ALLOWS THE HOT AIR (CONVECTION) TO FLOW EASILY THROUGH THE HERBS FOR EVEN HEAT DISTRIBUTION & EXTRACTION.
2. TURN OFF THE DEVICE WHEN NOT IN USE BY CLICKING THE POWER BUTTON 3 TIMES RAPIDLY WITHIN 2 SECONDS. THIS WILL PRESERVE THE HERBS & BATTERY LIFE.

OLED DIGITAL SCREEN DISPLAYS:



POWER
ON/OFF



LOW
BATTERY



CHARGING



ERROR
OCCURRED



SESSION
TIMER
(AUTO SHUT-OFF)
COUNTDOWN



TEMPERATURE
SETTING

HOW TO LOAD DRY HERBS:

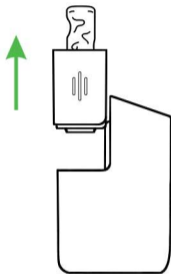

1. REMOVE THE MOUTHPIECE

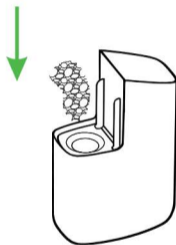

2. LOAD HERBS LOOSELY

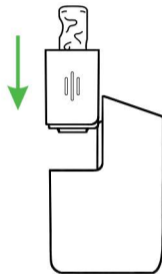

3. REPLACE THE MOUTHPIECE & ENJOY!

HOW TO USE GLASS ACCESSORIES:



1. REMOVE THE COOLING STEM FROM THE MOUTHPIECE.

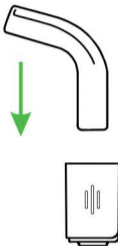

2. INSERT AN ALTERNATIVE GLASS ACCESSORY (SOLD SEPARATELY) INTO THE MOUTHPIECE.

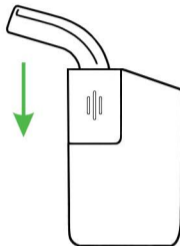

3. CONNECT THE MOUTHPIECE TO THE DEVICE & ENJOY!

HOW TO CLEAN THE CHAMBER:

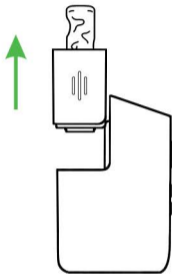

1. REMOVE THE MOUTHPIECE

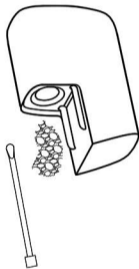

2. REMOVE THE MATERIAL FROM THE CHAMBER



3. USE THE CLEANING BRUSH TO REMOVE ANY REMAINING MATERIAL FROM THE CHAMBER

HOW TO CLEAN OR REPLACE THE O-RING:

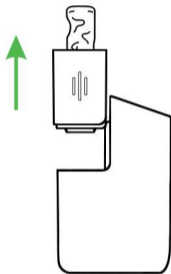

1. REMOVE THE MOUTHPIECE

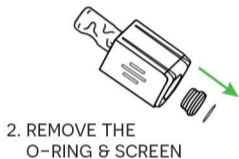

2. REMOVE THE O-RING & SCREEN

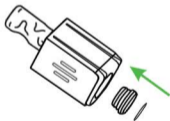

3. REPLACE THE NEW/CLEANED O-RING & SCREEN

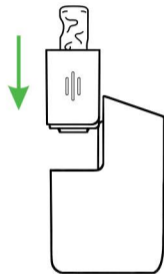

4. REPLACE THE MOUTHPIECE & ENJOY!

DEEP CLEANING – RECOMMENDED EVERY WEEK:

1. REMOVE THE MOUTHPIECE.
2. EMPTY THE CHAMBER.
3. REMOVE THE O-RING FROM THE MOUTHPIECE.
4. REMOVE THE SCREEN FROM THE O-RING & BRUSH THEM USING ISO ALCOHOL – THEN RINSE WITH WATER.
5. DAMPEN A Q-TIP WITH ISO ALCOHOL & WIPE OUT THE CHAMBER & GLASS MOUTHPIECE. **DO NOT DRIP ANY LIQUIDS INTO THE CHAMBER.**
6. PRESS THE O-RING BACK ONTO THE MOUTHPIECE.
7. PUT THE MOUTHPIECE BACK ONTO THE DEVICE & TURN IT ON FOR 2 MINUTES TO BURN-OFF ANY CLEANING RESIDUE.

HR
FURY EDGE

